



mesa·az

AGENDA  
ITEM 4c  
DATE 12-8-08

## City Council Report

**Date:** December 08, 2008  
**To:** City Council  
**Through:** Jack Friedline, Deputy City Manager  
**From:** Elizabeth Huning, City Engineer  
**Subject:** Gas Main Extension, Gantzel Road - Bella Vista Road to South of Union Pacific Railroad  
City of Mesa Project No. 07-025-001

### **Purpose and Recommendation**

The purpose of this report is to provide information to the Council on the results of the bids received for Project No. 07-025-001, a Gas Main Extension on Gantzel Road from Bella Vista Road to south of Union Pacific Railroad (See Exhibit "A" for project location).

It is recommended that the Council award this project to the low bidder, Mastec North America, Incorporated, for a total award of \$234,187.91.

### **Background**

The new Florence High School is being constructed on Gantzel Road approximately one mile north of Bella Vista Road in Pinal County. The City provides the gas service in this area from the City's Magma system and has agreed to supply natural gas to the school. The alignment of the new gas main required to serve the high school parallels the route proposed for a larger 8-inch high pressure gas line that is needed to deliver gas from the El Paso Natural Gas transmission system to the City's system by the 2009-2010 heating season. The Gas System Master Plan has identified this gas main to be a critical component of infrastructure to meet the natural gas demands in the area. This project will install the proposed high pressure 8-inch gas transmission main to supply gas to the City's system in the same trench with the lower pressure 4-inch gas main to serve the high school and the area along Gantzel Road. It is significantly more cost-effective to install both of the mains together in a joint trench.

Community Impact – Temporary impacts to the area will include construction noise, traffic restrictions and dust. Once work is started, project completion is anticipated within sixty (60) calendar days.

### **Discussion**

The two new gas mains consist of 5,300 linear feet of 8-inch steel high pressure gas pipe and 5,300 linear feet of 4-inch polyethylene (P.E.) gas pipe installed parallel in a joint trench. The 4-inch gas main will serve the new Florence High School and

additional future customers that develop along Gantzel Road. The 8-inch high pressure gas main will be the first phase of a two-phase gas main extension to provide a critical feed from the Gantzel Road gate station (one of the City's two connections to the El Paso Natural Gas transmission main) to an existing high pressure line in Bella Vista Road serving the majority of the customers in the Magma gas system.

**Alternatives**

An alternative would be to not proceed with this project and not install the gas main extension. This is not recommended, since the City has an agreement with the Florence High School to serve natural gas to this area and needs the new mains to serve the Magma area and the larger 8-inch main is needed to supply the City's Magma system.

**Fiscal Impact**

The recommended total award of this project is \$ 234,187.91, which consists of a low bid of \$212,898.10 plus an additional \$21,289.81 (10% allowance for change orders). This project is funded from the Adopted FY 08/09 Gas Bond Capital program.

**Coordinated With**

The Utilities Department concurs with this recommendation.

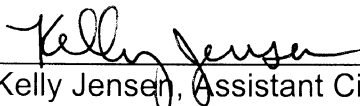
  
\_\_\_\_\_  
Kelly Jensen, Assistant City Engineer

  
\_\_\_\_\_  
Elizabeth Huning, City Engineer

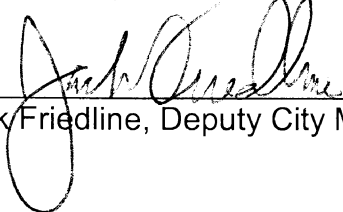
  
\_\_\_\_\_  
Jack Friedline, Deputy City Manager

**EXHIBIT "A"**  
**VICINITY MAP**  
**GANTZEL ROAD GAS MAIN EXTENSION**  
**BELLA VISTA ROAD TO SOUTH**  
**OF U.P.R.R. TRACKS**  
**PINAL COUNTY, ARIZONA**  
**C.O.M. PROJECT #07-025-001**

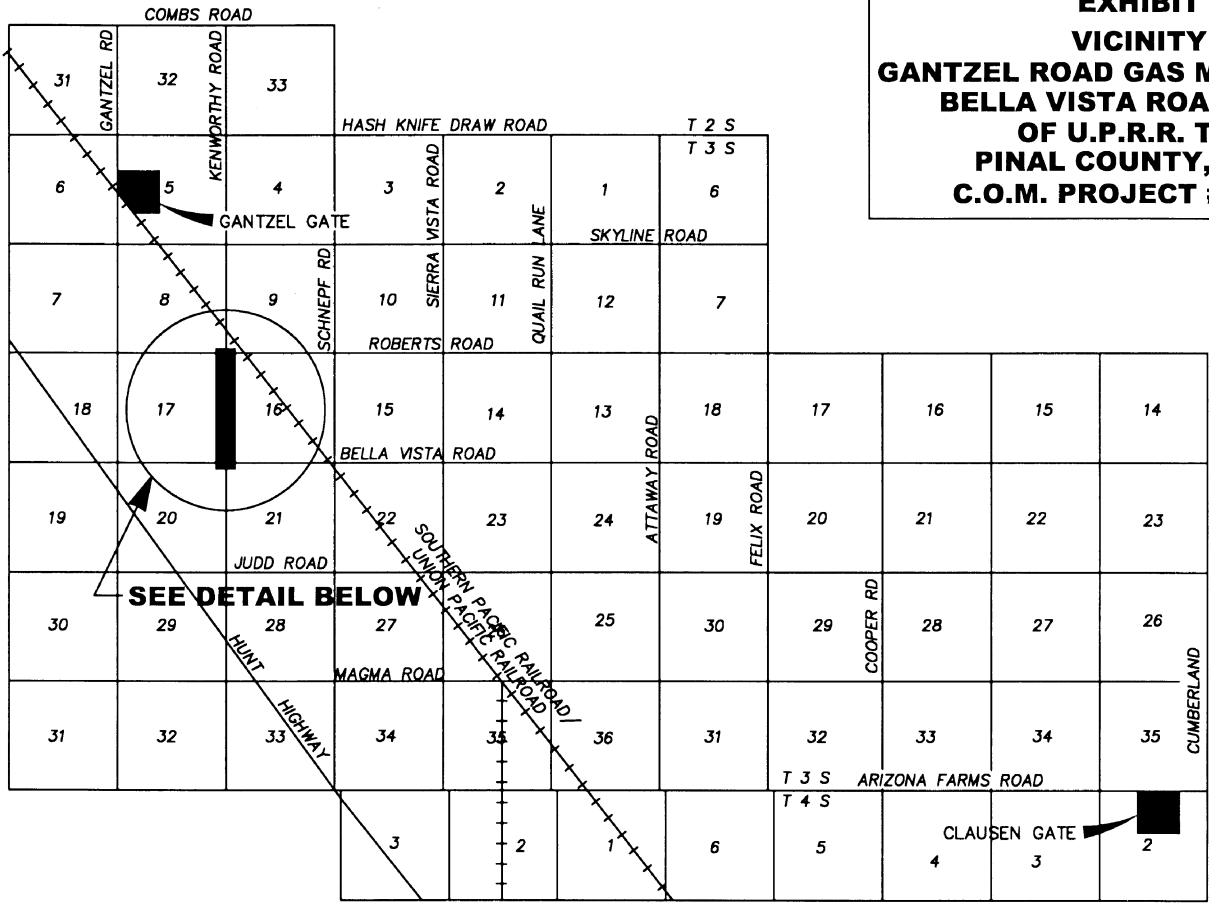

**VICINITY MAP**

SCALE: N.T.S.

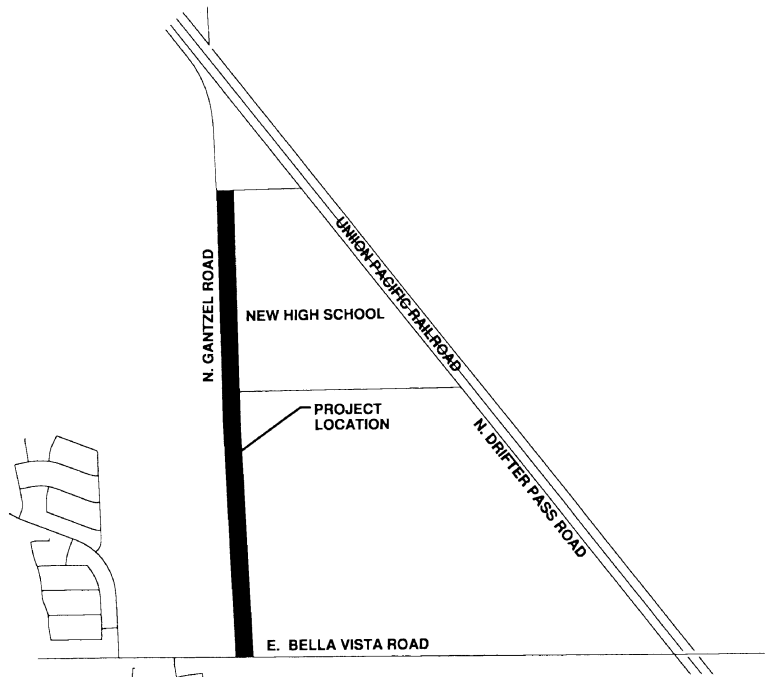

COM QUARTER SECTION 2303B



**DETAIL MAP**

SCALE: N.T.S.



ESPROJECT/07-025-001 GAS MAIN ON GANTZEL/CAD/COUNCIL MAP.DWG 11/25/08

Budget Information:  
FY 08/09 Gas Bond Capital Program

CITY OF MESA  
MESA, ARIZONA

GAS MAIN EXTENSION  
GANTZEL ROAD  
BELLA VISTA ROAD TO SOUTH OF UNION PACIFIC RAILROAD

**PROJECT NO. 07-025-001**

Tabulation of Bids Received, Thursday, November 13, 2008, at 2:30 P.M.

<b>ENGINEER'S ESTIMATE</b>	<b>\$289,440.00</b>
1. Mastec North America, Inc	\$212,898.10
2. Northern Pipeline Construction Co	\$223,155.00
3. Arizona Pipeline Company, Inc	\$379,470.00

Recommend award to low bidder, Mastec North America, Inc., in the amount of \$212,898.10 plus an additional \$21,289.81 (10% allowance for change orders) for a total award of \$234,187.91.

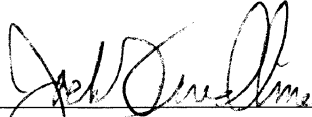

---

Jack Friedline  
Deputy City Manager