



mesa·az Transportation Advisory Board Report

Date: April 21, 2009
To: Transportation Advisory Board
From: Randi Davis, Traffic Studies Analyst
Subject: Turn Prohibitions From Driveways on Alma School Road North of 8th Street

Purpose and Recommendation

Fire Station #218 is in the process of being constructed at 845 North Alma School Road. The project includes an emergency traffic signal for vehicles exiting the fire station. Traffic from two nearby driveways could conflict with exiting emergency vehicles. To prevent these conflicts, turn prohibitions from these driveways should be in effect when the emergency traffic signal is active.

Background and Discussion

The City of Mesa is in the process of constructing Fire Station #218 at 845 North Alma School Road. Groundbreaking is tentatively scheduled for June 2009 with estimated completion in February 2010. As a result of neighborhood requests during the design review phase of the project, 9th Street will be cul-de-saced and closed east of Alma School Road. An emergency traffic signal will also be installed to control traffic during periods of fire preemption. Northbound traffic will be stopped by the existing traffic signal at Alma School Road and 8th Street during periods of fire preemption. A location map is attached. See Figure 1.

Alma School Road is a fully improved 88-foot wide seven lane arterial street which includes three through lanes in each direction, a two-way continuous left turn lane with exclusive left turn lanes at 8th Street, bicycle lanes, curb and gutter, sidewalks, and street lighting. On street parking is prohibited. The speed limit on Alma School Road is 40 mph from Baseline Road to 8th Street and 45 mph from 8th Street to the north City limits. Land use in the immediate vicinity of the fire station project is a mix of residential and commercial. The Mesa Mountain View Apartments complex is located on the northwest corner and a Circle K convenience store is located on the northeast corner of Alma School Road and 8th Street. There are single family residential properties located north of the apartment complex and fire station site which do not front onto Alma School Road. Both the Mesa Mountain View

Apartments and the Circle K have existing driveways along Alma School Road. See Figure 2.

To provide safe and efficient emergency vehicle access from the fire station driveway, it is recommended to prohibit eastbound turns from the driveway on the west side of Alma School Road with centerline approximately 330 feet north of 8th Street and to prohibit westbound turns from the driveway on the east side of Alma School Road with centerline approximately 213 feet north of 8th Street during those time periods when the emergency traffic signal fire preemption is activated.

Alternatives

One alternative is to not prohibit turns from the subject driveways. The result could be crashes attributed to conflicts between emergency vehicles entering Alma School Road and vehicles exiting the subject driveways during periods of emergency traffic signal fire preemption.

Fiscal Impact

The four internally illuminated “No Turns” signs required to indicate the turn prohibitions at both driveways are already included in the construction project and will have no additional fiscal impact to implement.

Coordinated With

The property owners/managers of the Mesa Mountain View Apartments and the Circle K have been contacted regarding the turn prohibitions during periods of emergency traffic signal fire preemption from their respective driveways and they have indicated their concurrence.

Randi Davis, Traffic Studies Analyst

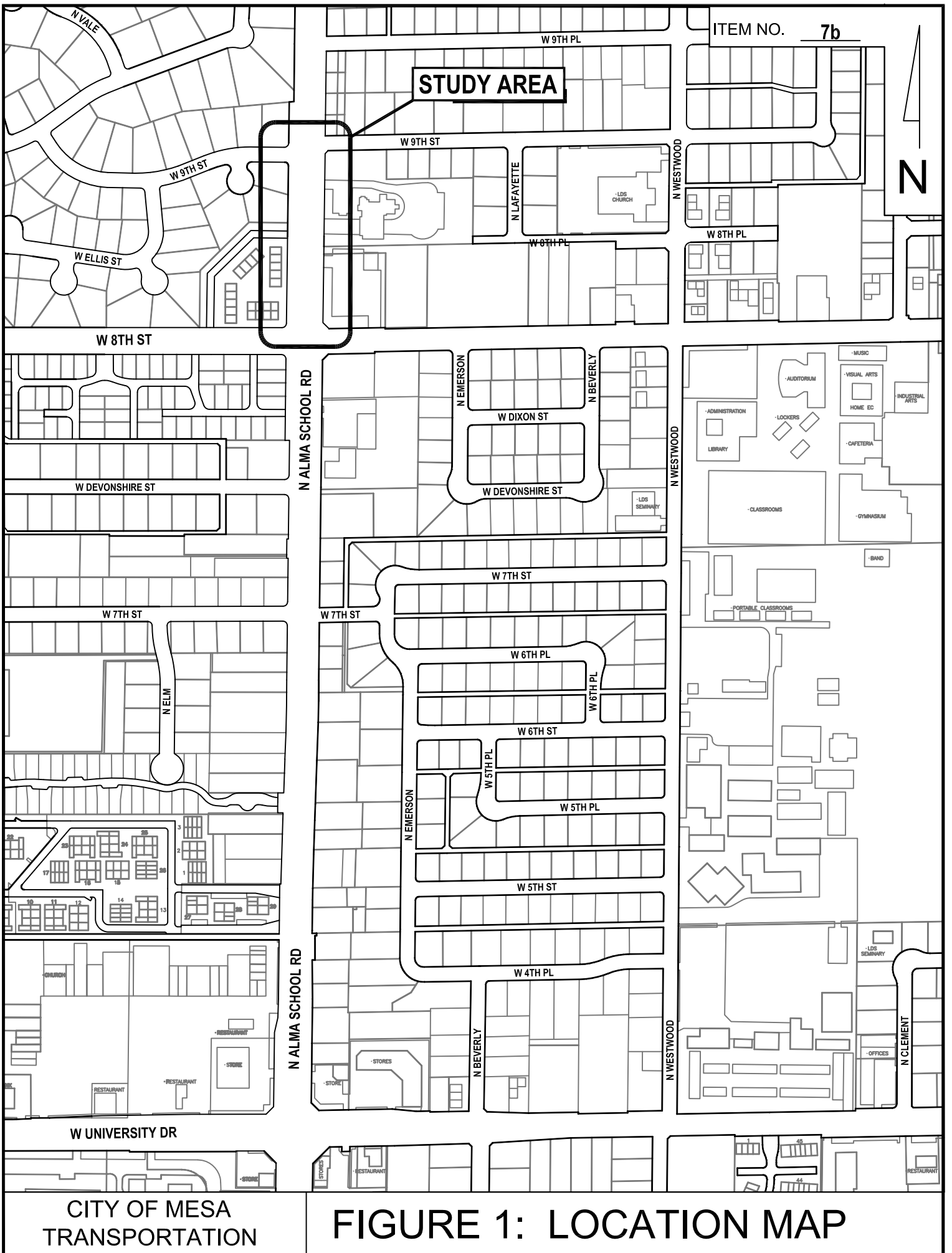

STUDY AREA

ITEM NO. **7b**

N

