

# ENCLOSE CARPORT TO LIVABLE AT THE \_\_\_\_\_ RESIDENCE

## APPLICABLE CODES

ALL CONSTRUCTION SHALL COMPLY WITH THE FOLLOWING CODES AND AMENDMENTS:  
 2018 IRC INTERNATIONAL RESIDENTIAL CODE  
 CITY OF MESA AMENDMENTS

DRYER SHALL NOT VENT INTO ROOM

IDENTIFY ALL GAS APPLIANCES IN UTILITY, LAUNDRY AND STORAGE ROOMS, SHOW LOCATIONS AND SIZES OF ALL COMBUSTION AIR VENTS

OUTLETS

ATTIC ACCESS TO REMAIN

EXISTING POSTS AND BEAMS TO REMAIN IN PLACE

ADD ROOM NAMES OF ADJACENT ROOMS

ALL EXTERIOR DOORS AND WINDOWS SHALL COMPLY WITH CITY'S SECURITY ORDINANCE NO. 2225

HOW IS ROOM HEATED AND COOLED?  
 \_\_\_\_\_

WATER HEATER SHALL NOT DRAIN INTO ROOM

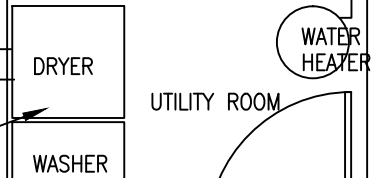

ROOM NAME= \_\_\_\_\_

ADD SMOKE DETECTOR IF A BEDROOM



NEW/EXIST LIGHT

NEW SWITCH

PORCH LIGHT



WINDOW TYPE

36" DR.

12'-0" MAX

FLOOR PLAN

PUT DIMENSIONS AT THE CIRCLES

PROPERTY ADDRESS=

CITY OF MESA - FOR REFERENCE ONLY - EXAMPLE



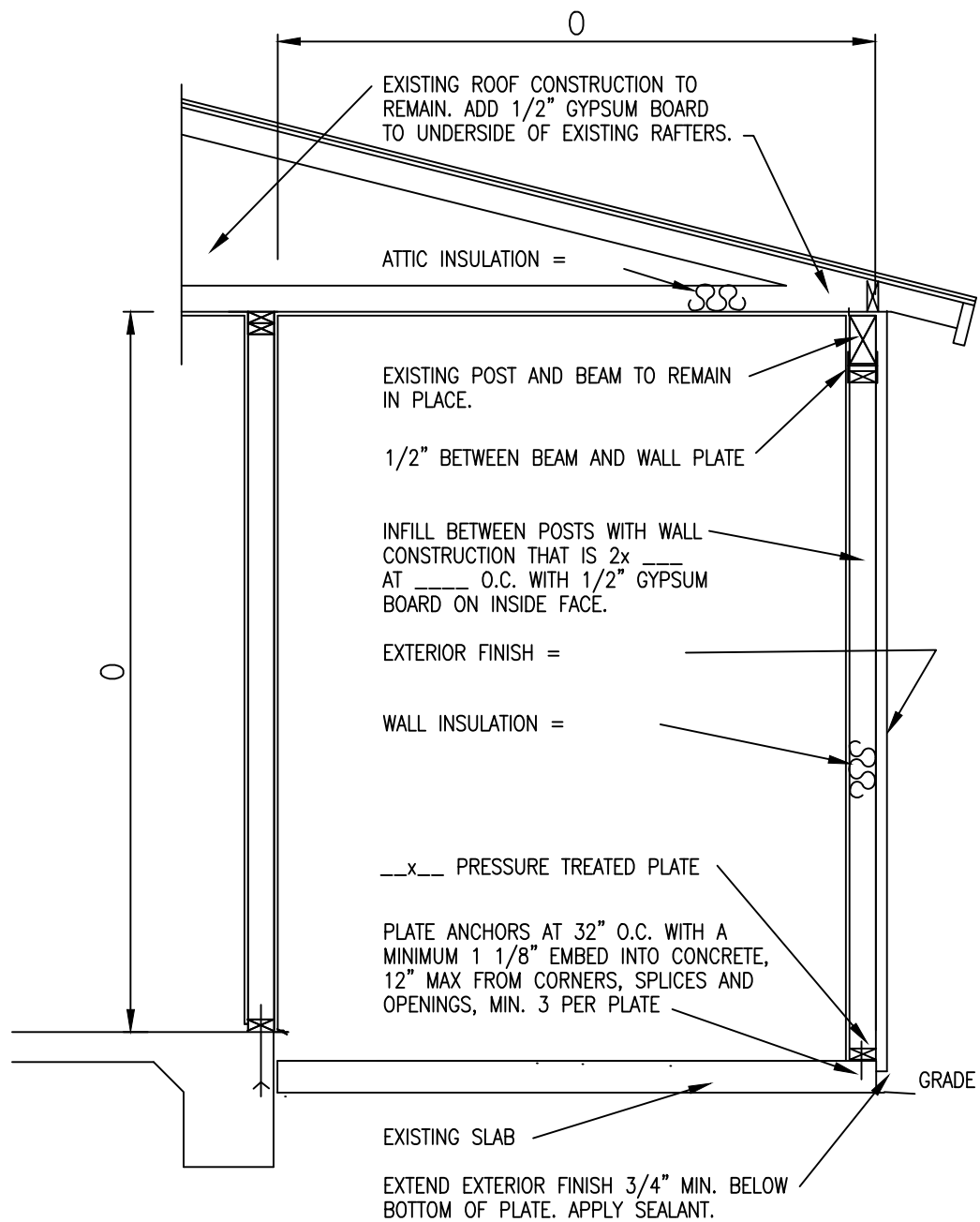

ENCLOSURE

PUT DIMENSIONS AT THE CIRCLES  
 ALL METAL CONNECTORS SHALL BE  
 ICC LISTED AND INSTALLED PER  
 MANUFACTURER'S INSTRUCTIONS

PROPERTY ADDRESS=

CITY OF MESA – FOR REFERENCE ONLY – EXAMPLE