

ENCLOSE CARPORT TO GARAGE AT THE _____ RESIDENCE

APPLICABLE CODES

ALL CONSTRUCTION SHALL COMPLY WITH THE FOLLOWING CODES AND AMENDMENTS:
 2018 IRC INTERNATIONAL RESIDENTIAL CODE
 CITY OF MESA AMENDMENTS

DRYER SHALL NOT VENT INTO ROOM

IDENTIFY ALL GAS APPLIANCES IN UTILITY, LAUNDRY AND STORAGE ROOMS, SHOW LOCATIONS AND SIZES OF ALL COMBUSTION AIR VENTS

DOORS SHALL BE SOLID CORE WITH AUTOMATIC SELF-CLOSURES

GFCI OUTLETS IN RATED WALLS REQUIRE METAL OR U.L. LISTED PLASTIC J-BOXES

ATTIC ACCESS TO REMAIN

EXISTING POSTS AND BEAMS TO REMAIN IN PLACE

ADD ROOM NAMES OF ADJACENT ROOMS

NO WINDOWS PERMITTED

ALL WALLS ADJACENT TO LIVABLE AREAS AND THE GARAGE CEILING SHALL HAVE 1/2" GYPSUM BOARD. GARAGES BENEATH LIVABLE SPACES SHALL HAVE 5/8" GYPSUM BOARD.

SHOW ELECTRICAL PANELS

SHOW WALL AND CEILING FINISHES

FLOOR PLAN

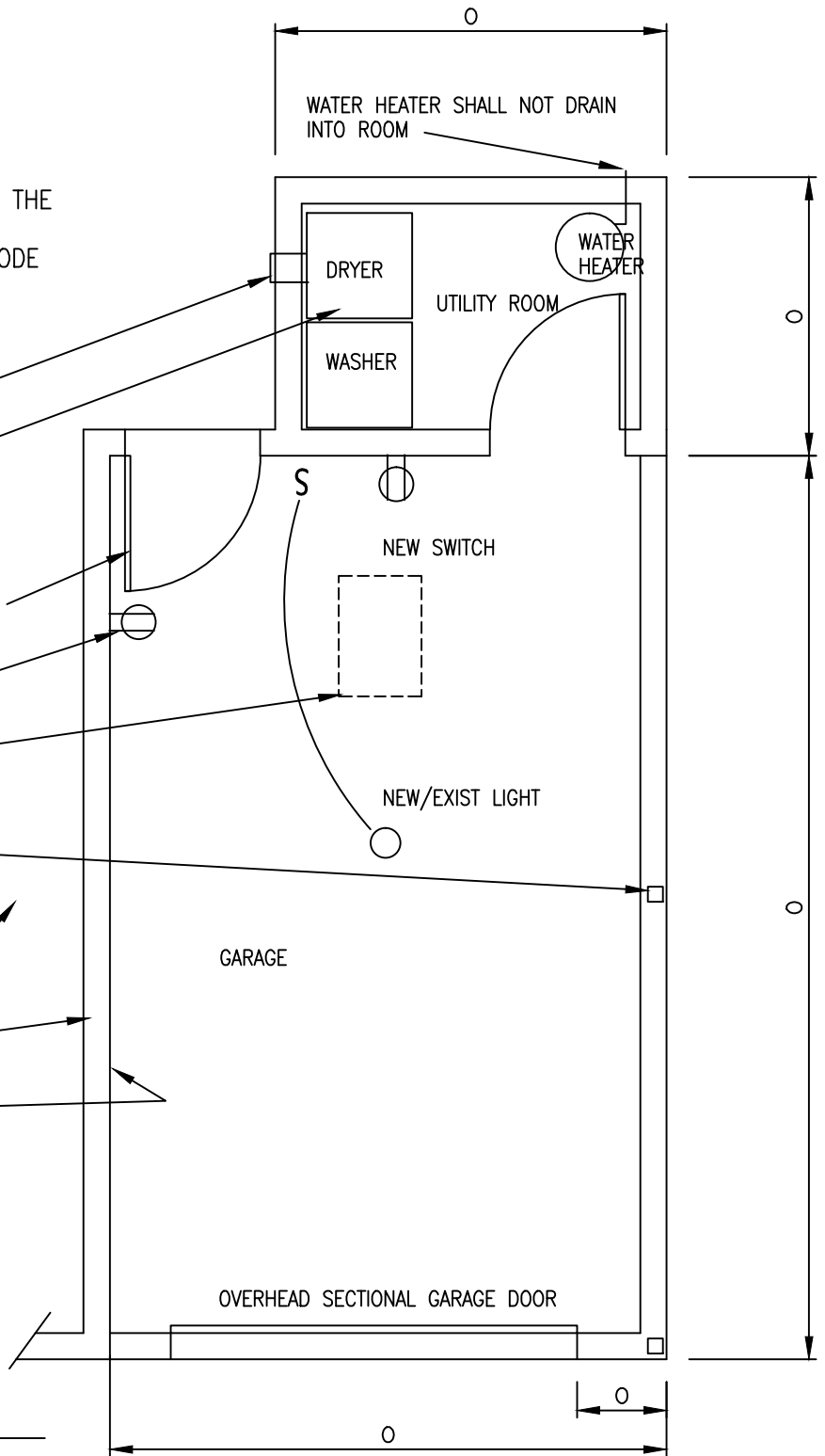

PUT DIMENSIONS AT THE CIRCLES

PROPERTY ADDRESS=



CITY OF MESA – FOR REFERENCE ONLY – EXAMPLE

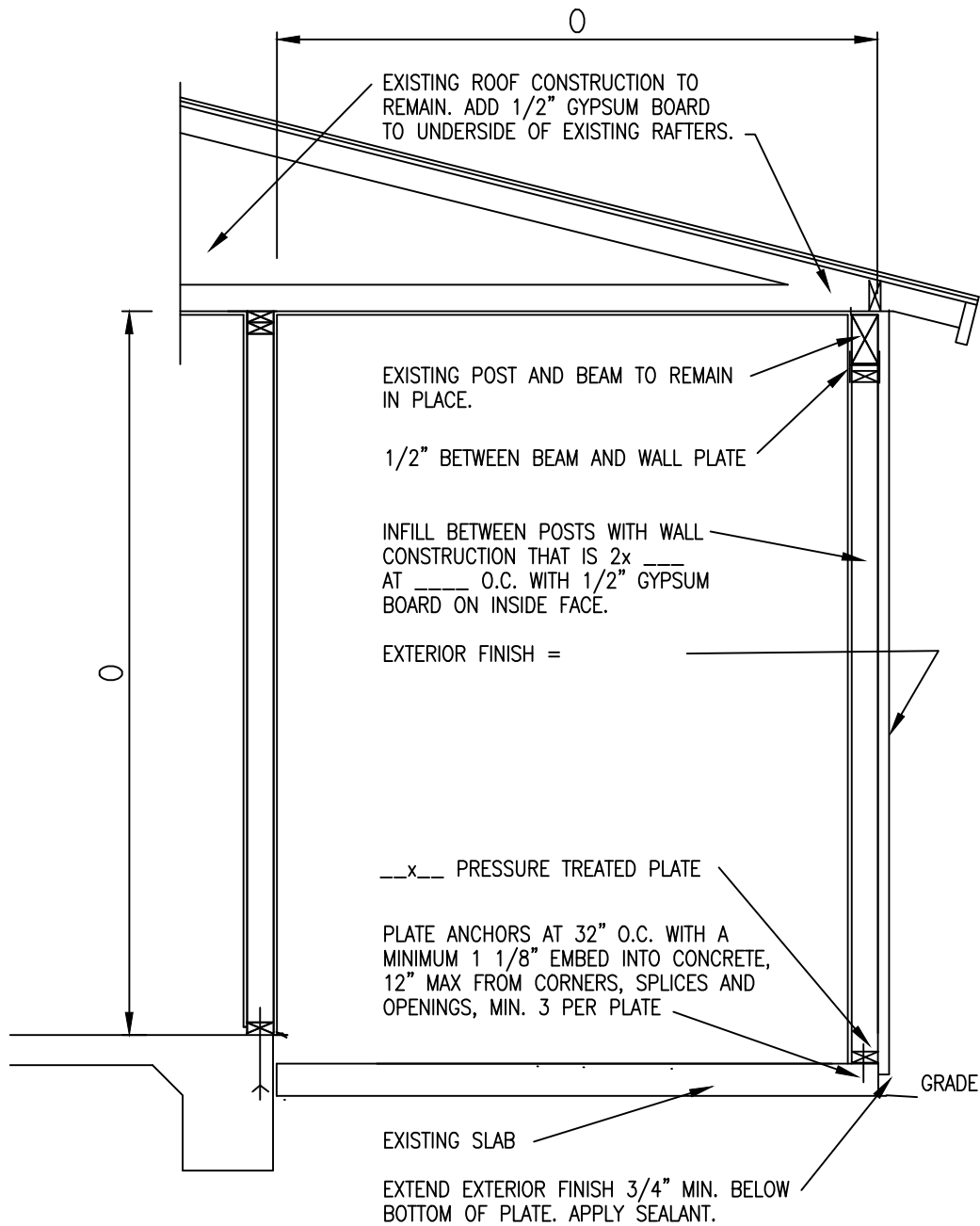

ENCLOSURE

PUT DIMENSIONS AT THE CIRCLES

ALL METAL CONNECTORS SHALL BE ICC LISTED AND INSTALLED PER MANUFACTURER'S INSTRUCTIONS

PROPERTY ADDRESS=

CITY OF MESA - FOR REFERENCE ONLY - EXAMPLE